

Backplate

Product sheet

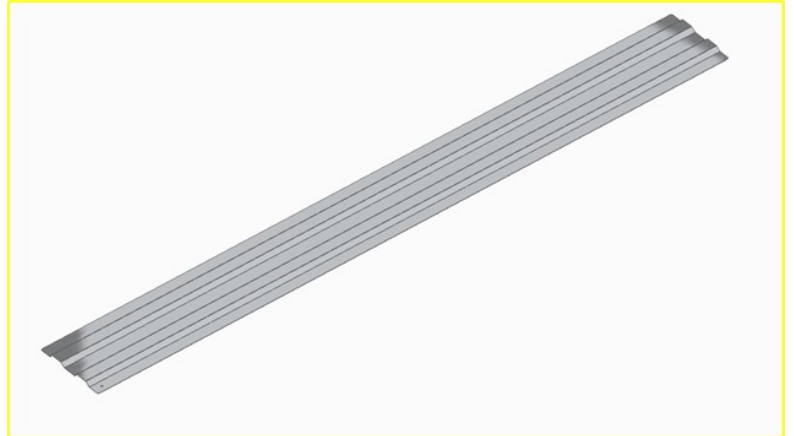
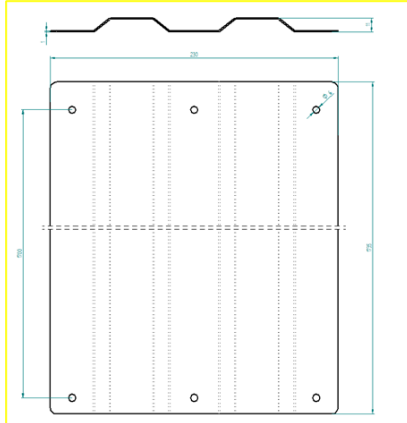

Weight of the gravel loading: Evenly filled grooves, about 16kg per plate; about 10 kg per plate per additional cm of fill

Technical Details

| | |
|-------------------------|--|
| Material | <i>Alum</i> |
| Design & Use | <i>The robust aluminum plates boast a specialized geometry tailored for their intended purpose. Designed to accommodate various loading options, these plates can be conveniently weighted using existing gravel on the roof or concrete weights such as sidewalk plates. It's crucial to note that the plates should never be mounted lengthwise beneath the support structure.</i> |
| Warranty | <i>10 years according to our Guarantee Terms and Conditions.</i> |
| Length | <i>1735 mm</i> |
| Height | <i>11 mm</i> |
| Width | <i>230 mm</i> |
| Colour | <i>Silver</i> |
| Weight | <i>3300 gr</i> |

V1 PRODUCT SHEET